

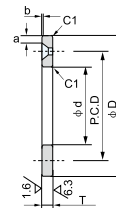

请从适用的内径、外径、长度中选择零件号
(例)内径30.2mm、厚度5mm的情况下

NTB-50W - 3005

请指定上述零件号

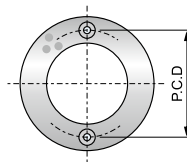
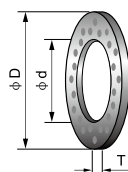

a b : 端面倒角 (mm)

d	a	b
~ 10.2	1.5	0.3
~ 18.2	2	0.4
~ 35.2	2.5	0.4
~ 45.2	3	0.5
~ 55.3	4	0.6
~ 100.5	5	0.8
~ 120.5	4	0.8

●能与OOB-50组合使用。

Parts No.	内径		外径	厚度		定位孔		
	∅ d		∅ D	T		P.C.D	个数	定位螺栓
NTB-50W-0603	6.2	$\begin{smallmatrix} +0.2 \\ +0.1 \end{smallmatrix}$	25	3	$\begin{smallmatrix} 0 \\ -0.1 \end{smallmatrix}$	15	2	M3
NTB-50W-0803	8.2	"	28	"	"	18	"	"
NTB-50W-1003	10.2	"	30	"	"	20	"	"
NTB-50W-1203	12.2	"	40	"	"	28	"	"
NTB-50W-1203N	"	"	"	"	"		无定位孔	
NTB-50W-1303	13.2	"	"	"	"	28	2	M3
NTB-50W-1403	14.2	"	"	"	"	"	"	"
NTB-50W-1503	15.2	"	50	"	"	35	"	"
NTB-50W-1603	16.2	"	"	"	"	"	"	"
NTB-50W-1603N	"	"	"	"	"		无定位孔	
NTB-50W-1803	18.2	"	"	"	"	35	2	M3
NTB-50W-2005	20.2	"	"	5	"	"	"	M5
NTB-50W-2505	25.2	"	55	"	"	40	"	"
NTB-50W-2505N	"	"	"	"	"		无定位孔	
NTB-50W-3005	30.2	"	60	"	"	45	2	M5
NTB-50W-3005N	"	"	"	"	"		无定位孔	
NTB-50W-3505	35.2	"	70	"	"	50	2	M5
NTB-50W-4007	40.2	$\begin{smallmatrix} +0.2 \\ +0.1 \end{smallmatrix}$	80	7	$\begin{smallmatrix} 0 \\ -0.1 \end{smallmatrix}$	60	2	M6
NTB-50W-4507	45.2	"	90	"	"	70	"	"
NTB-50W-5008	50.3	$\begin{smallmatrix} +0.3 \\ +0.1 \end{smallmatrix}$	100	8	"	75	4	"
NTB-50W-5508	55.3	"	110	"	"	85	"	"
NTB-50W-6008	60.3	"	120	"	"	90	"	M8
NTB-50W-6508	65.3	"	125	"	"	95	"	"
NTB-50W-7010	70.3	"	130	10	"	100	"	"
NTB-50W-7510	75.3	"	140	"	"	110	"	"
NTB-50W-8010	80.3	"	150	"	"	120	"	"
NTB-50W-9010	90.5	"	170	"	"	140	"	M10
NTB-50W-10010	100.5	"	190	"	"	160	"	"
NTB-50W-12010	120.5	"	200	"	"	175	"	"

注：本公司可以按客户需求，生产非标产品。Note: we can produce as per your drawings.